

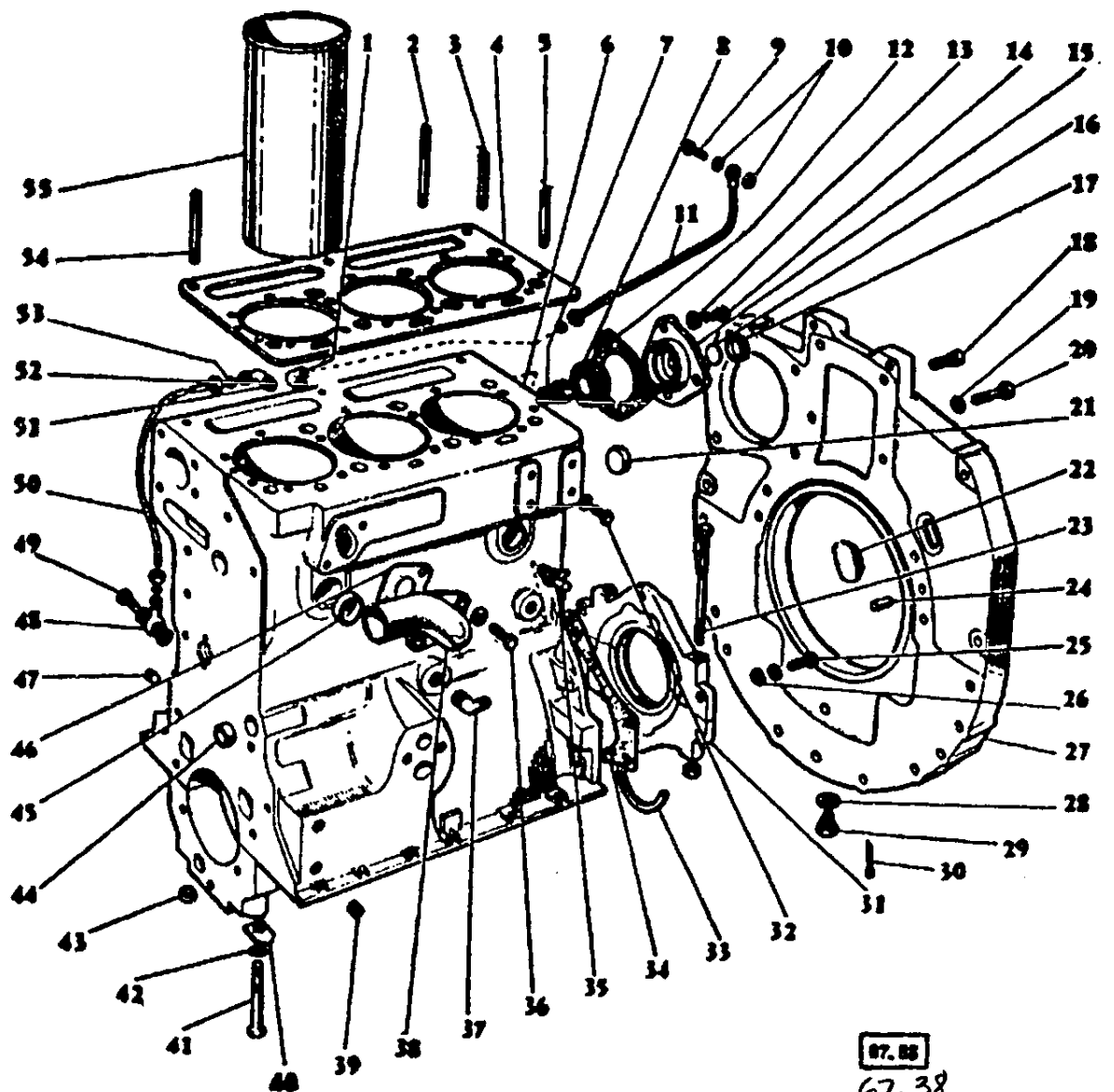

BLOC CYLINDRE
CYLINDER BLOCK
ZYLINDERBLOCK
BASAMENTO MOTORE

3



VILBERBOURN
CRANKSHAFT
KURBELWELLE
ALBERO MOTORE

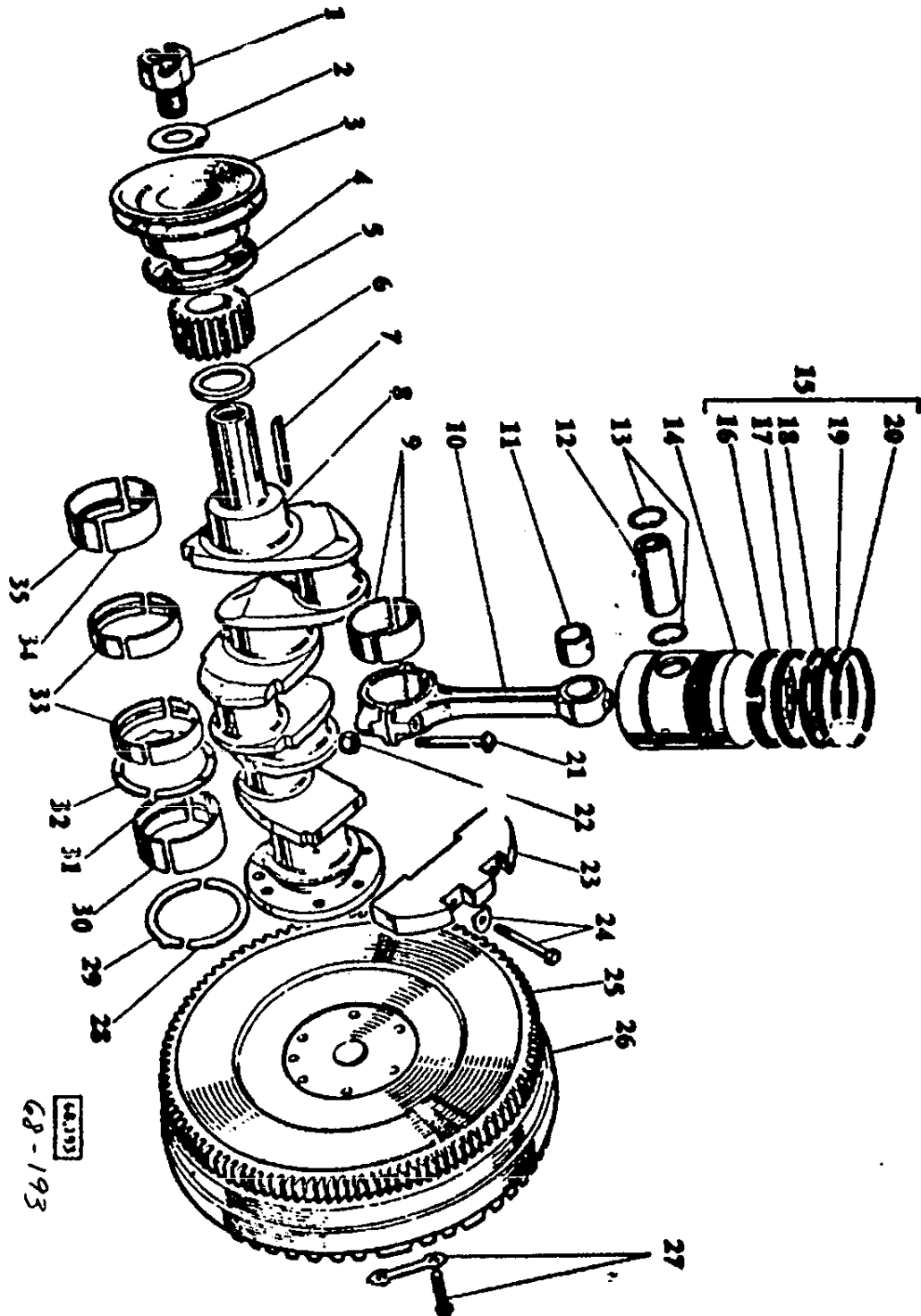

68-193

made in France

PERKINS AD 3.152

957 238 M2 - Emulsion 2 - VII/88

CULASSE
CYLINDER HEAD
ZYLINDERKOPF
TESTA CILINDRI

11

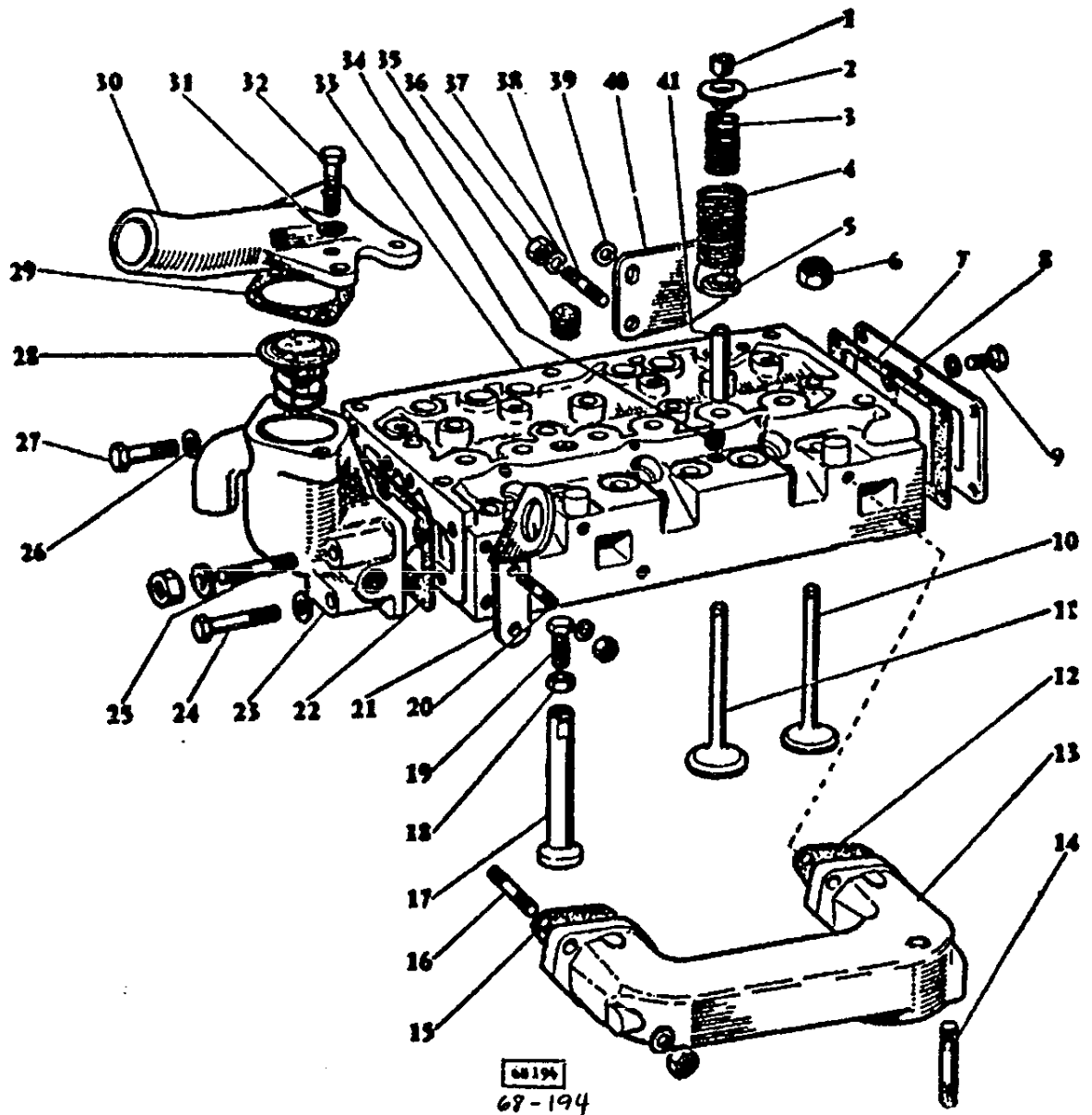

68194
68-194

imprimé en France

PERKINS AD 3.152

867 236 M2 - Emission 2 - VII/88

F1

CACHE-CULBUTEURS
CYLINDER HEAD COVER
ZYLINDERKOPFDECKEL
COPERCHIO PER TESTA CILINDRI

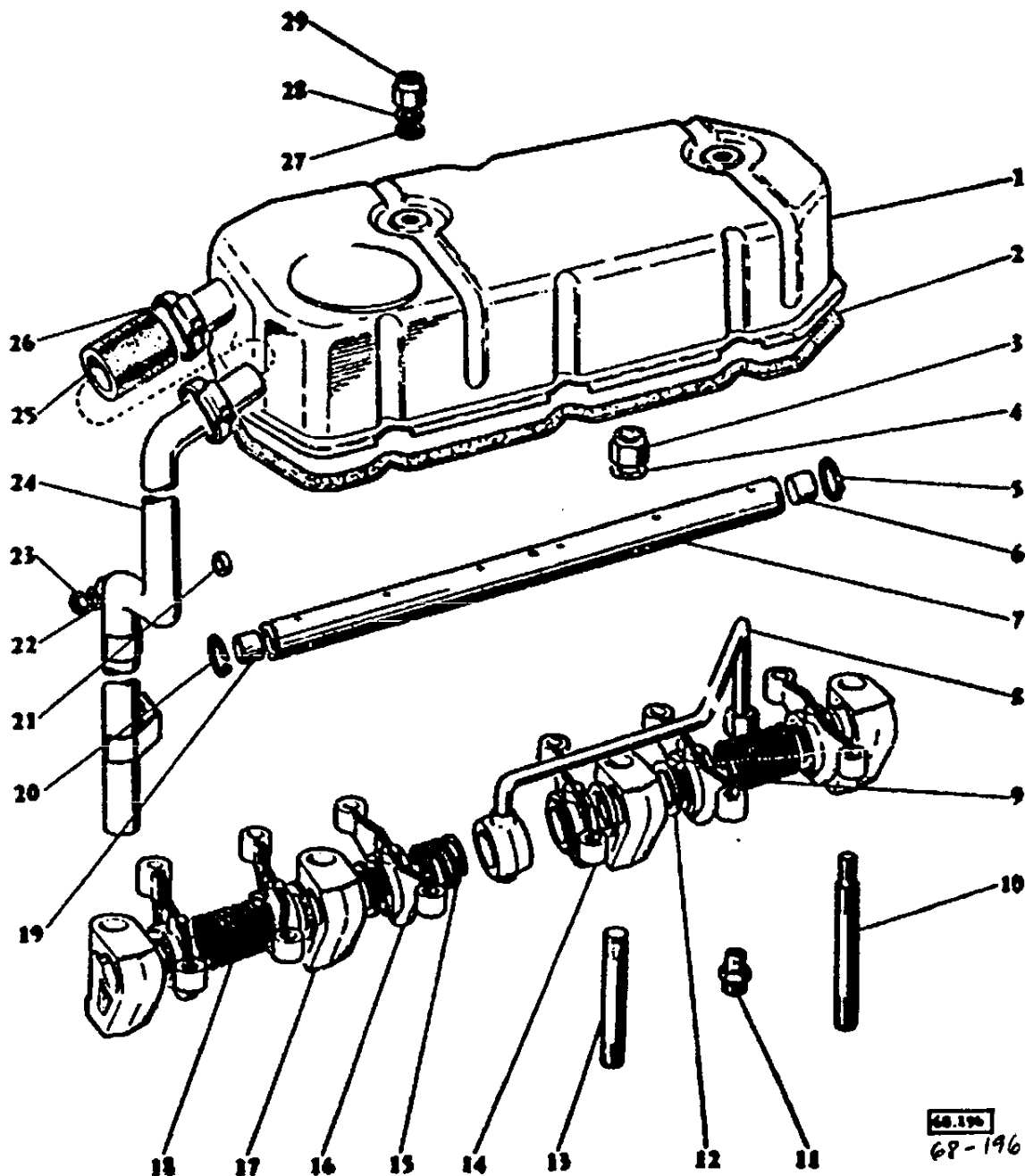

68.196
68-196

DISTRIBUTION
TIMING GEAR
STEUERGETRIEBE
DISTRIBUZIONE

10

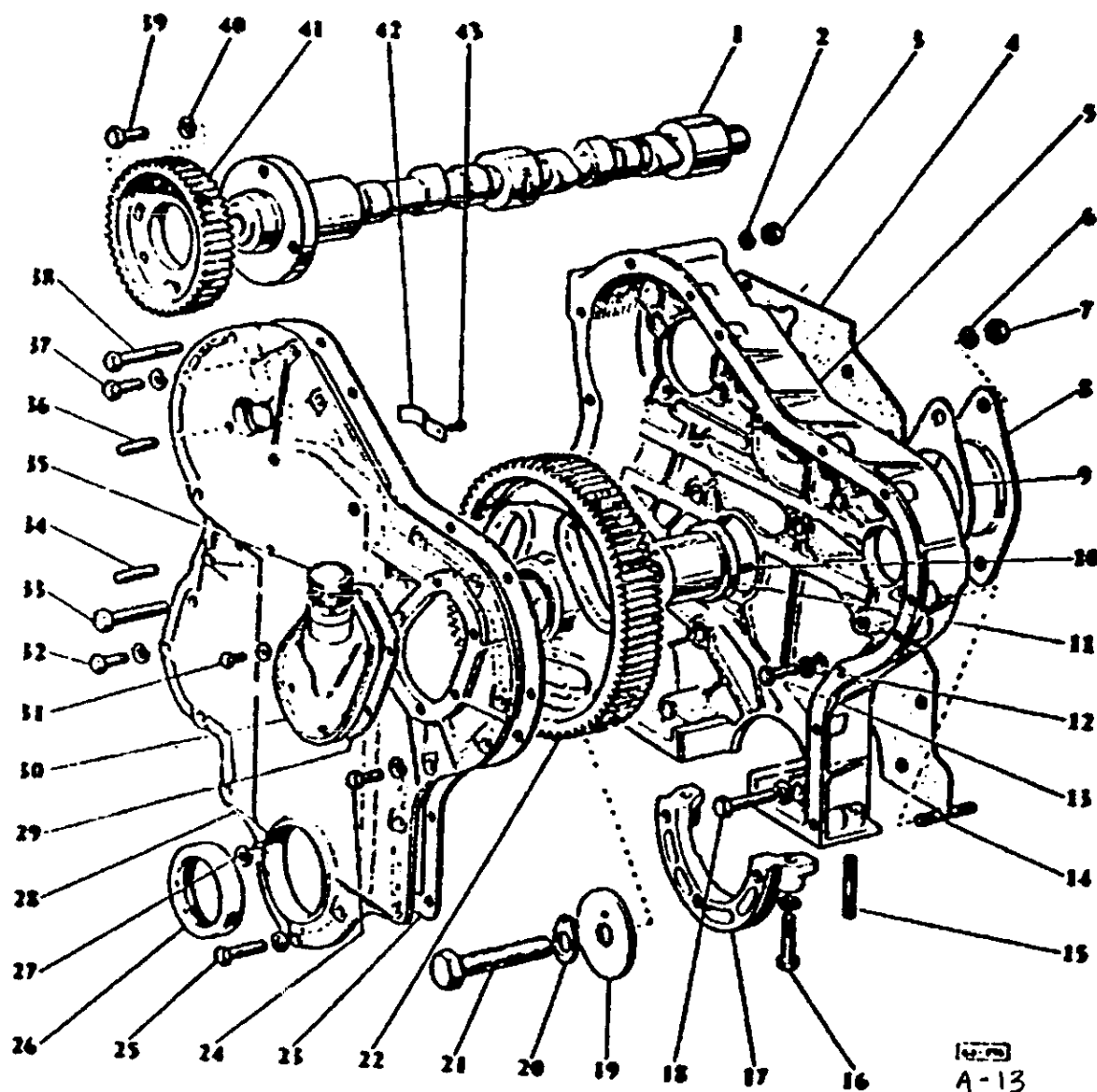

A-13

Imprimé en France

PERKINS AD 3.152

957 236 M2 - Emission 1 - IV/67

in

F

EQUIPEMENT D'INJECTION
FUEL INJECTION EQUIPMENT
EINSPRITZGERÄTUNG
IMPIANTO INIEZIONE

10

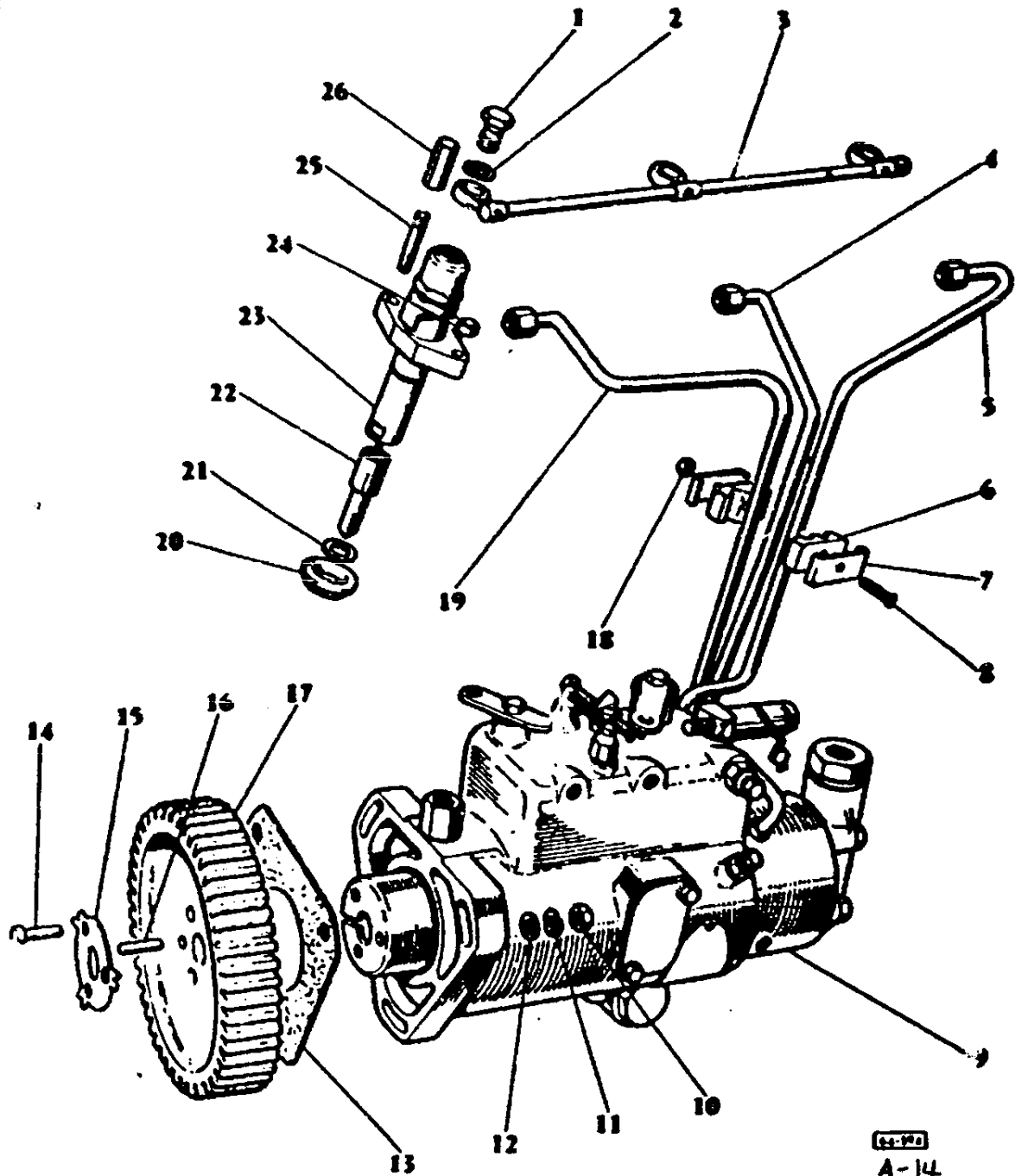

Imprimé en France

PERKINS AD 3.152

057 236 M2 - Emission 2 - VR/88

LUBRICATING
LUBRICATING OIL SYSTEM
SCHMIERÖL-ANLAGE
LUBRICAZIONE

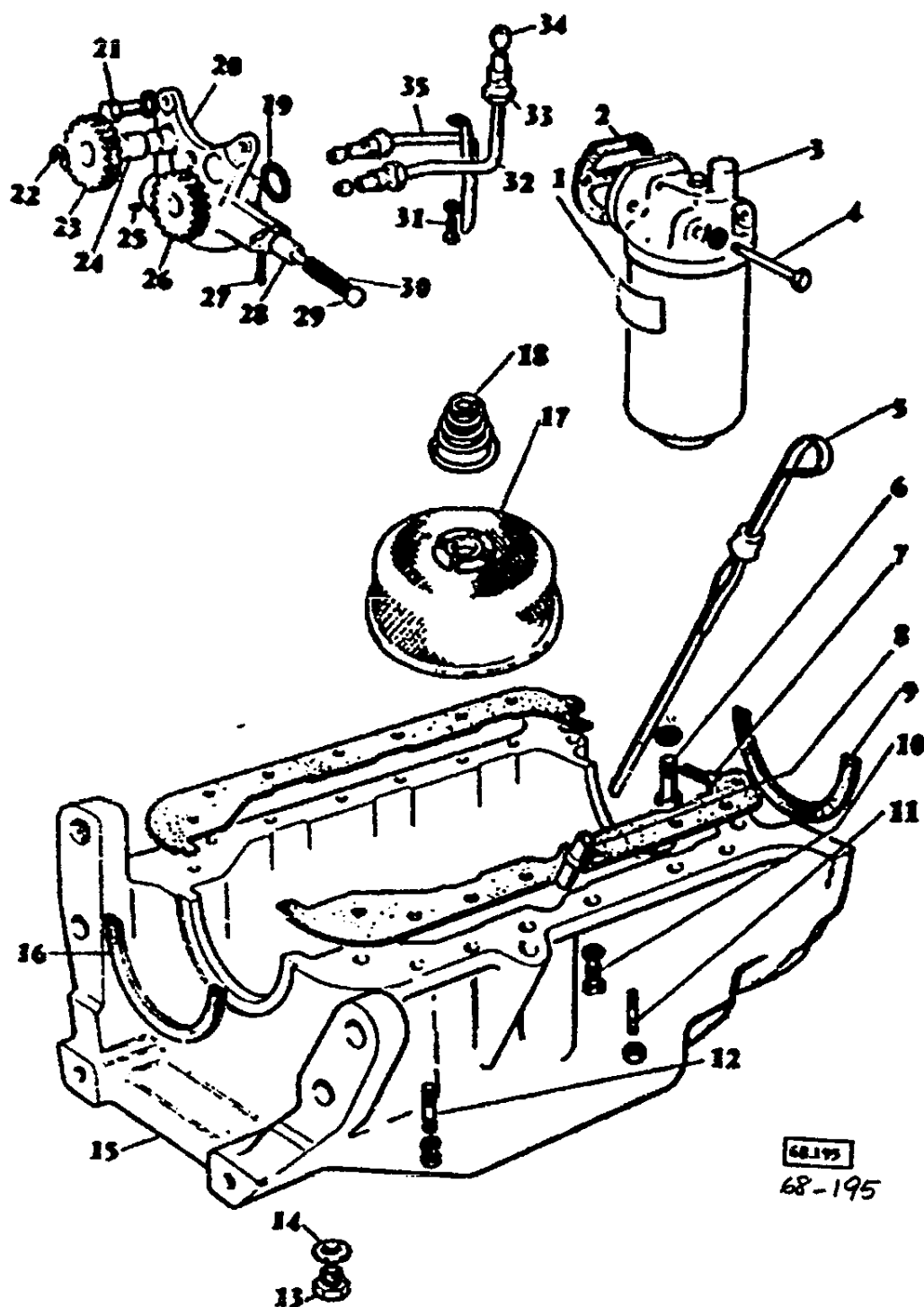

68.195
68-195

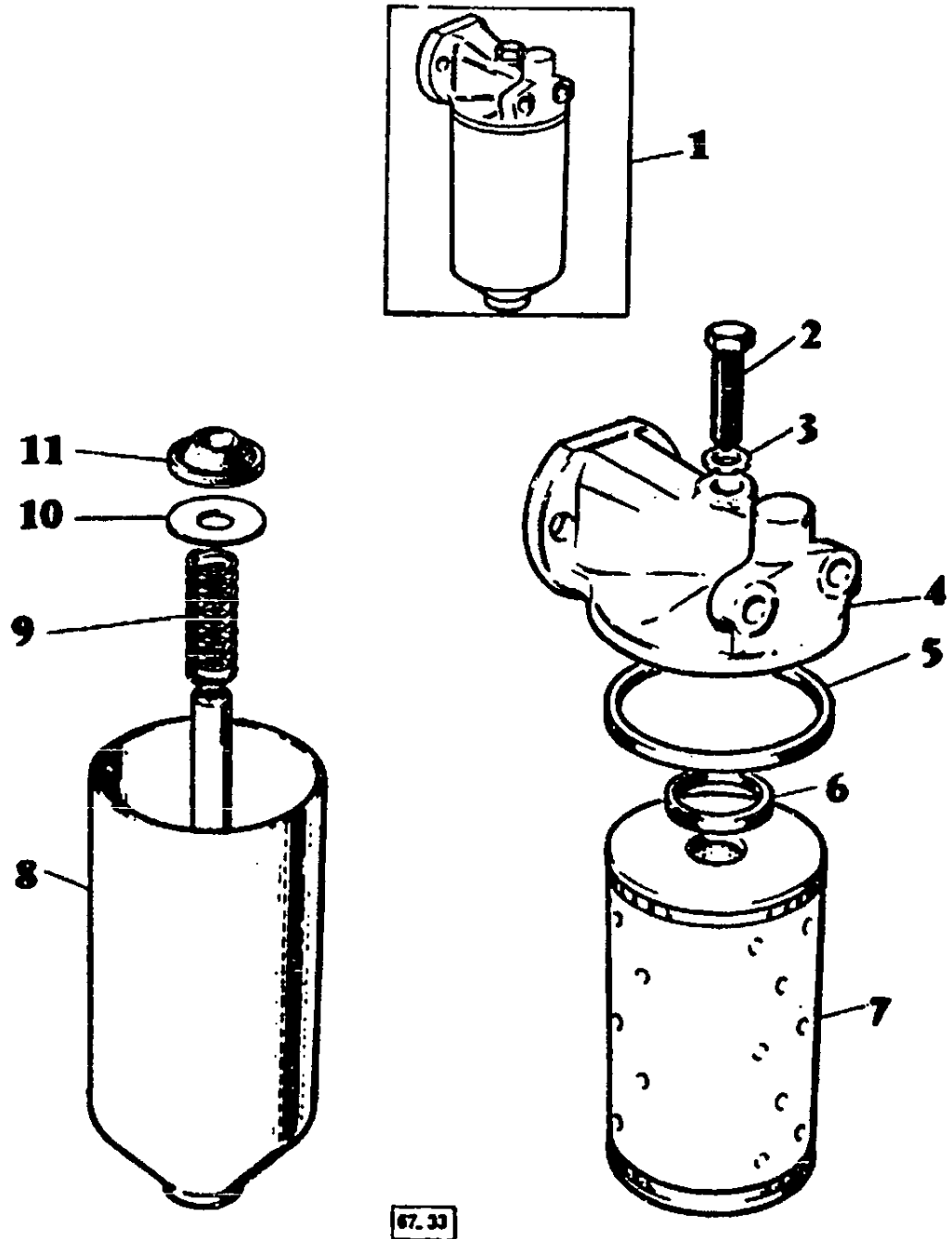

67.33

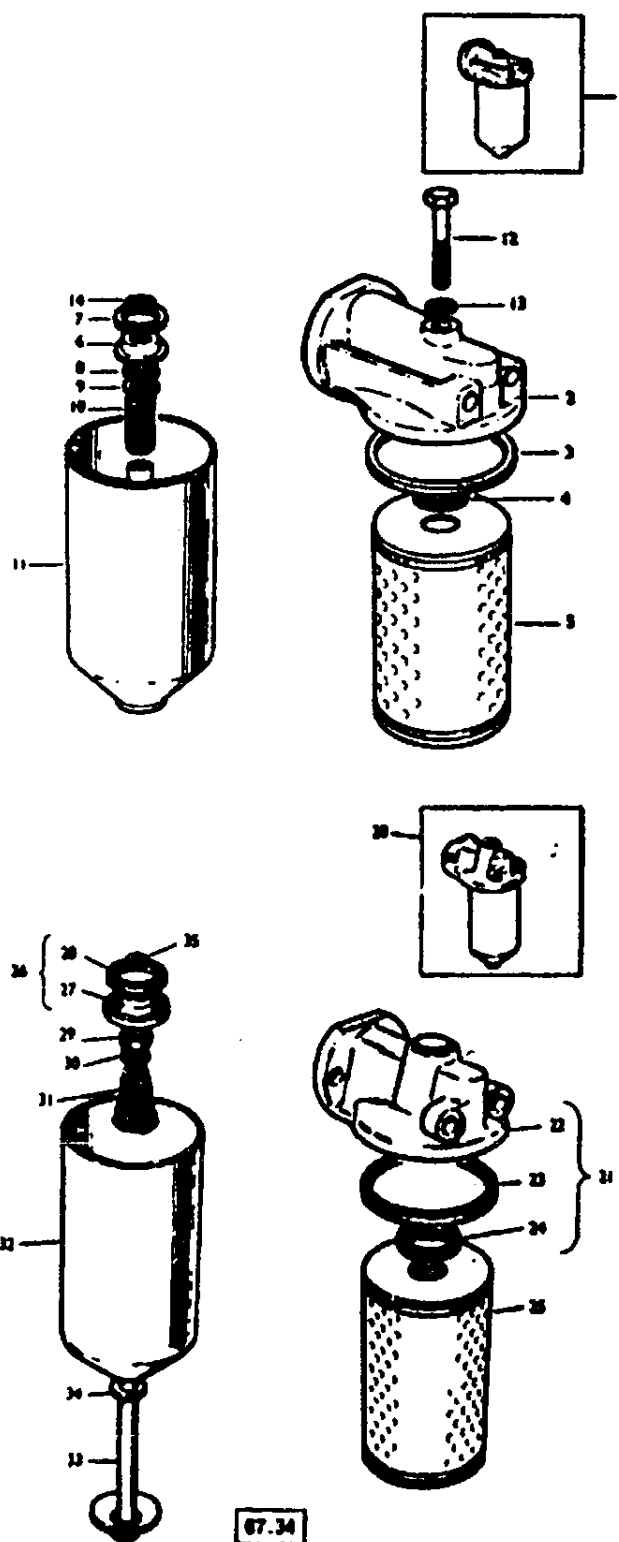

POMPE A EAU
WATER PUMP
WASSER PUMPE
POMPA ACQUA

27

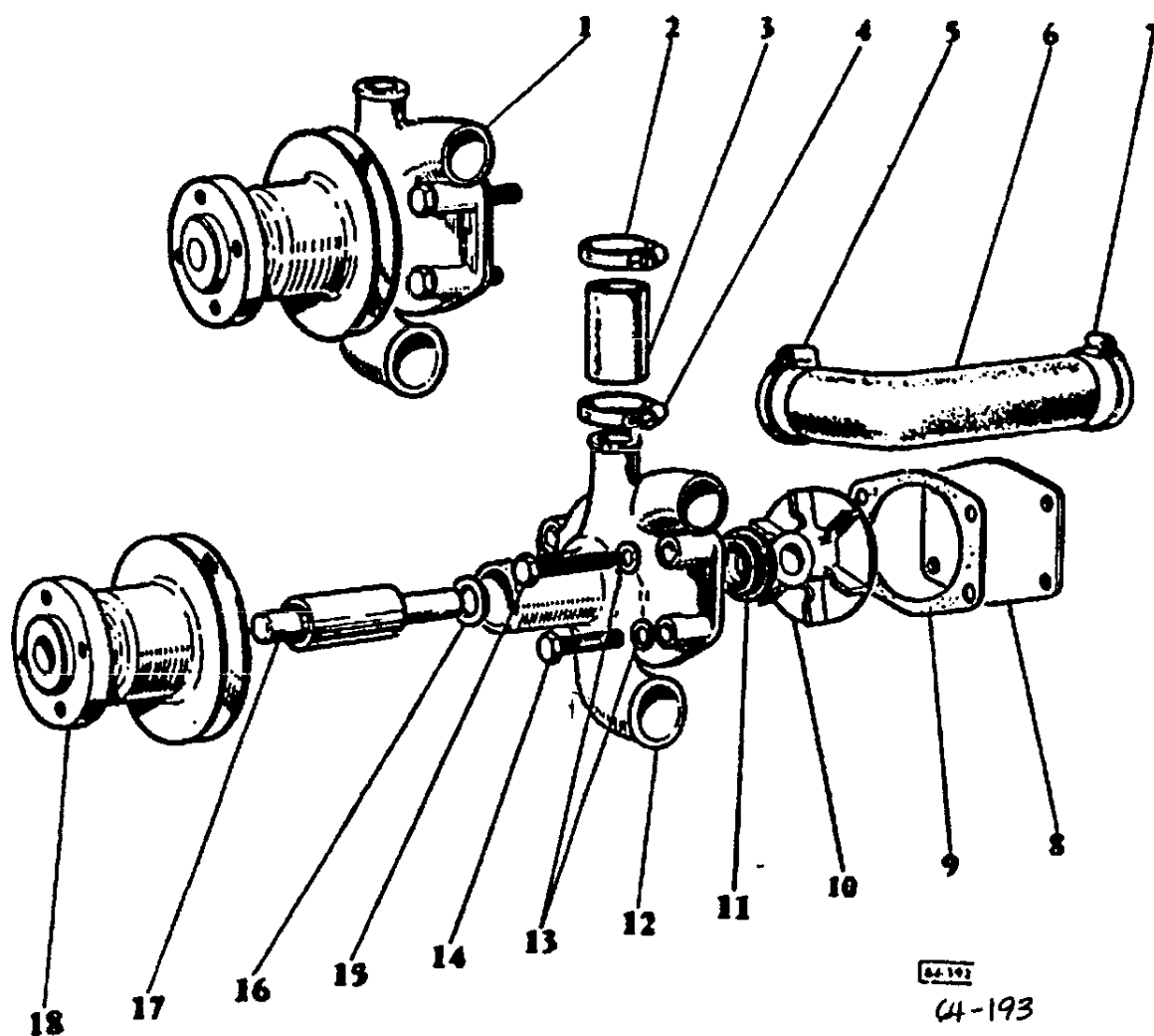

POMPE D'ALIMENTATION - Jusqu'au n° 144 FA 5131 (Tracteur MF 133)
 - Jusqu'au n° 144 FA 5200 (Tracteur MF 35, 35 X, 135)

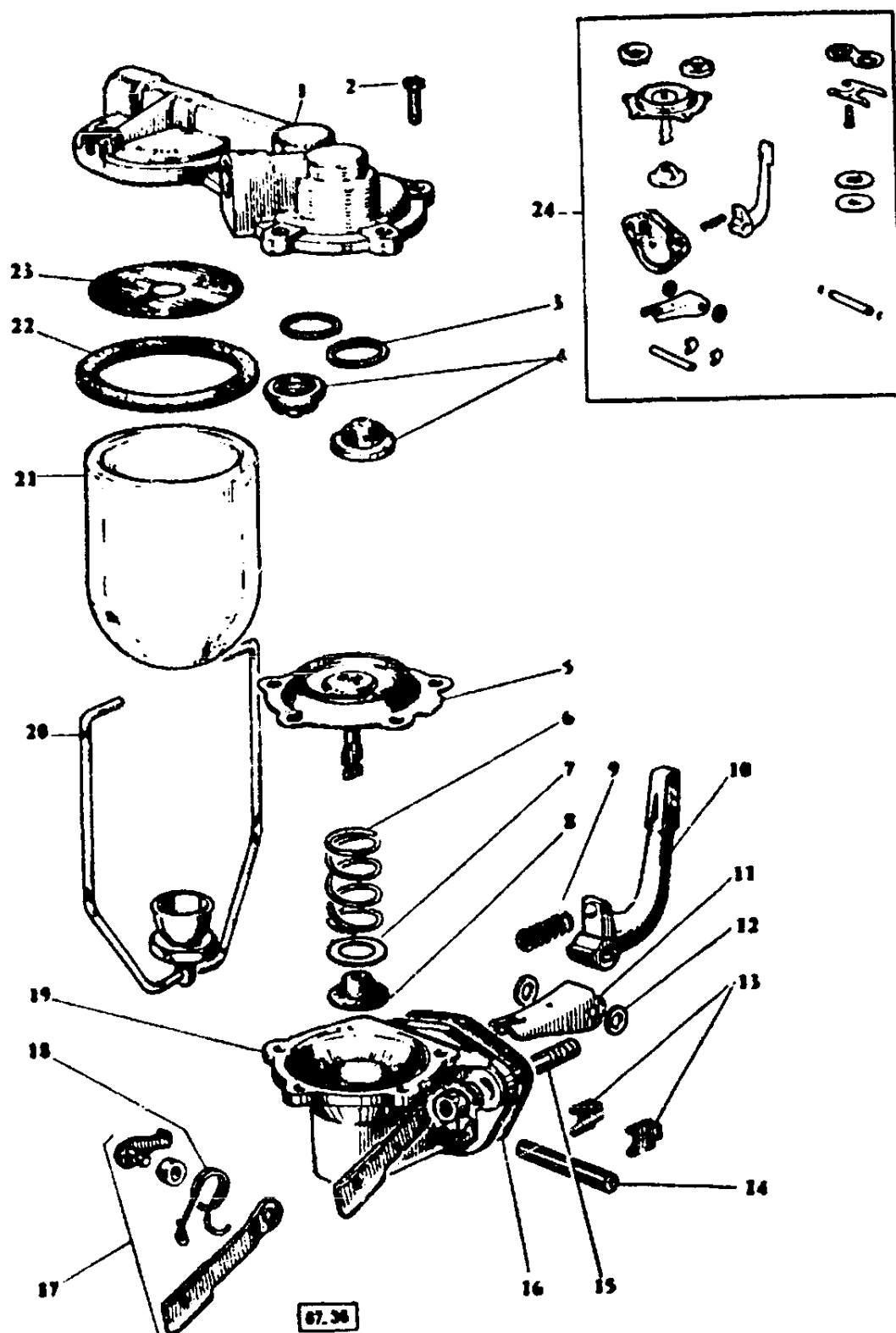

POMPE D'ALIMENTATION

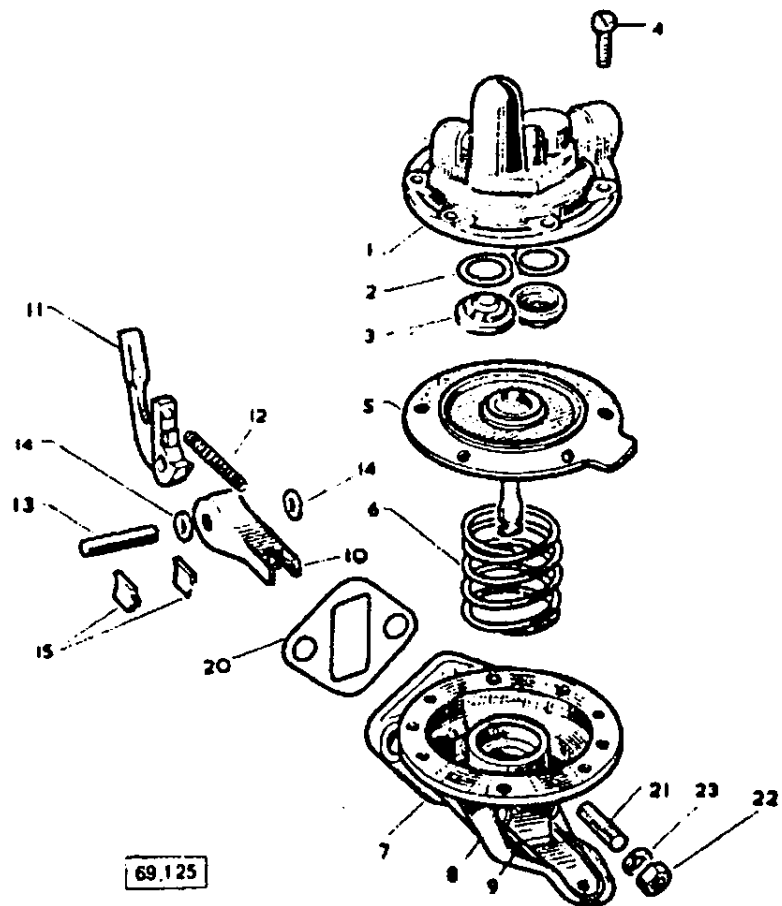

SYSTEME ADMISION D'AIR
AIR INDUCTION SYSTEM
LUFTANSUGGEHAUSE
ASPIRAZIONE ARIA

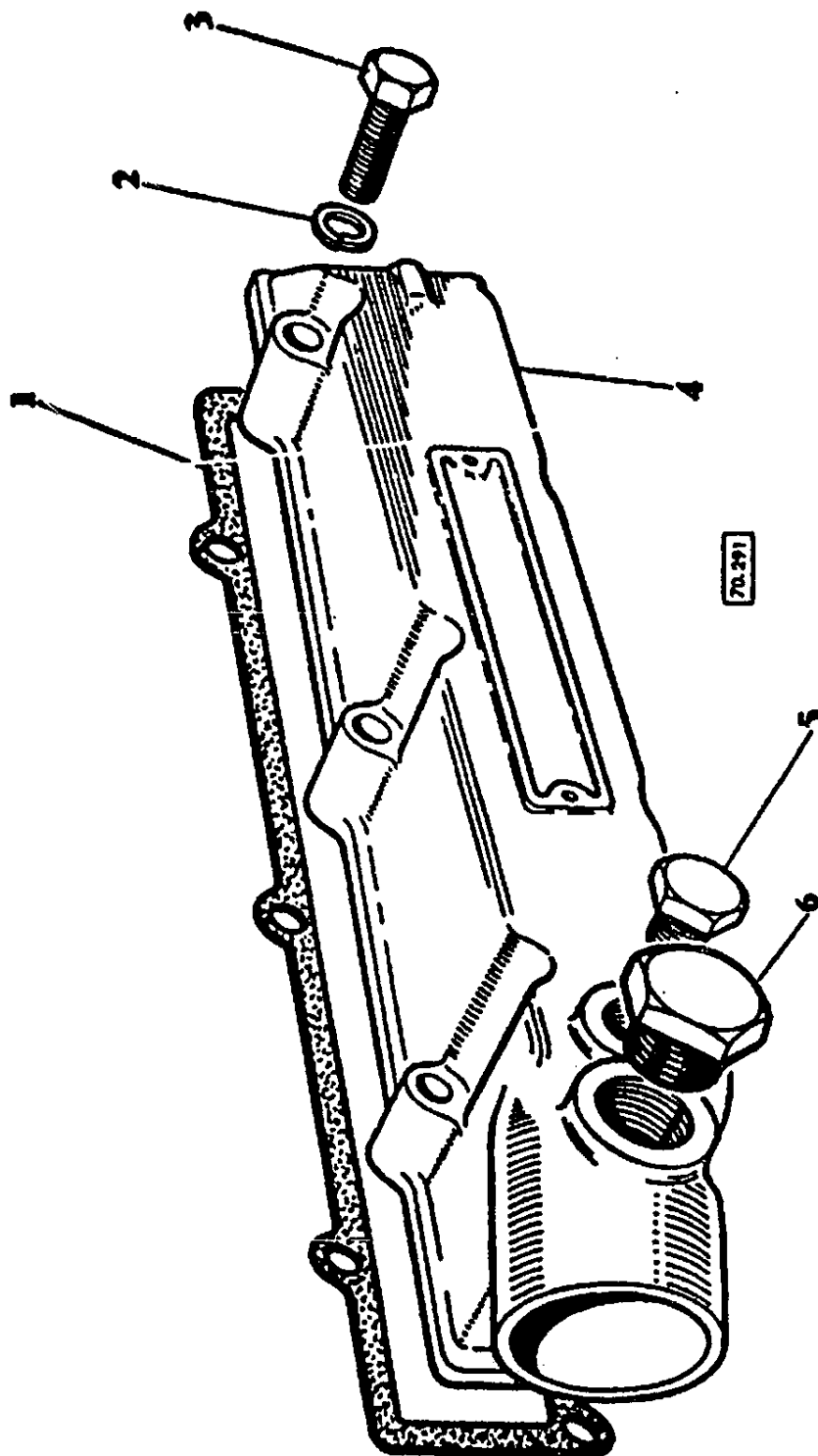

POCHETTE DE JOINTS
SET JOINTS
DICHTUNGSATZ OBERSTE TEIL
SERIE QUARINZIONI

25

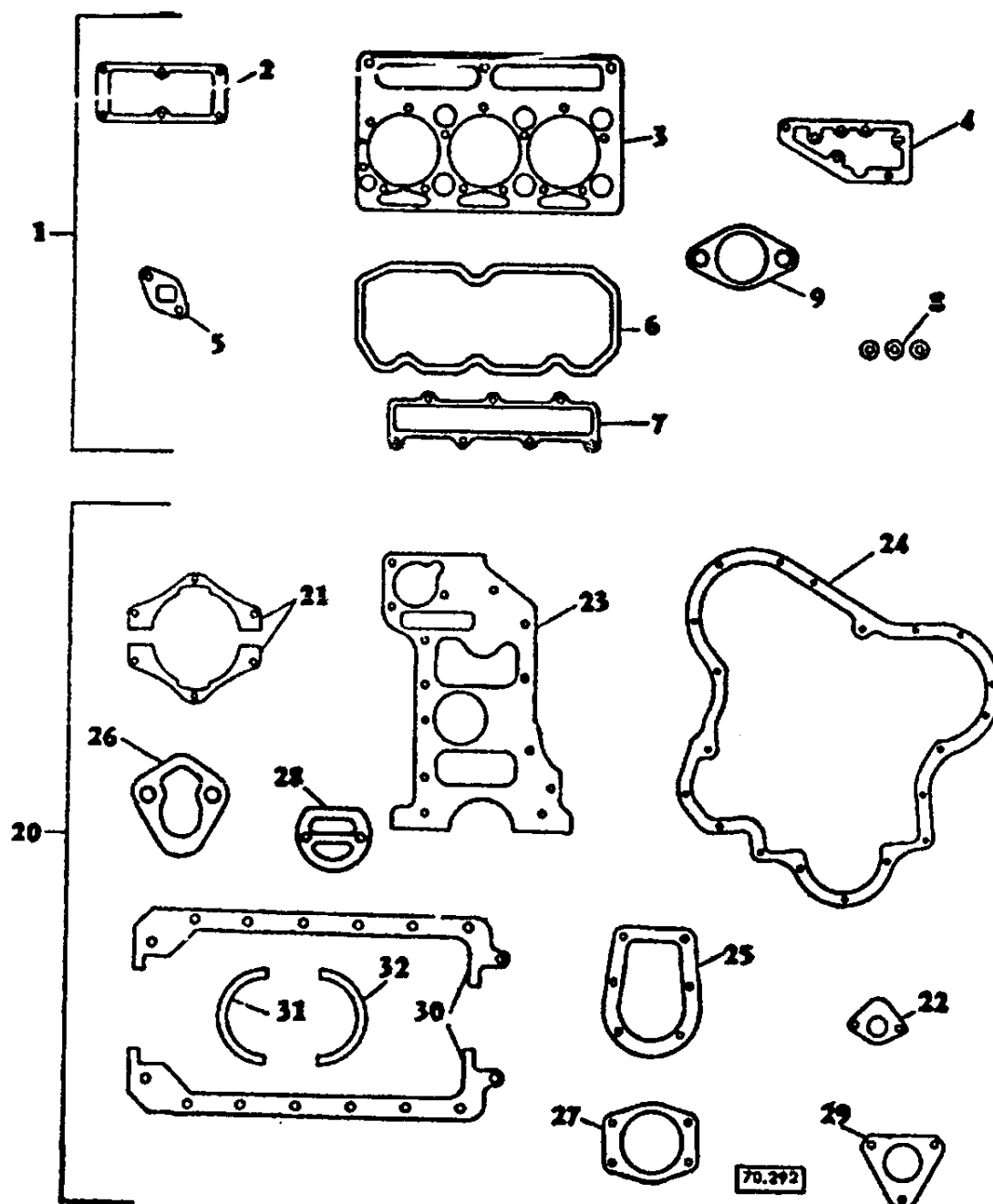

Imprimé en France

PERKINS AD 3.152

957 236 M2 - Emission 2 - II/71

G